

## CHAPTER 5

# The Leigh eBush

### Joint Fit Adjustment

### eBushes and Adaptors

### eBush Adaptor Selection

**Note:** Normal tolerances with bits, guide bushings and router runout will generally produce poor fitting joints. Leigh elliptical guide bushings (e7 and e10) solve this problem.

Patents for all Leigh elliptical guide bushings: U.S. 8,256,475 UK GB2443974

### Joint Fit Adjustment

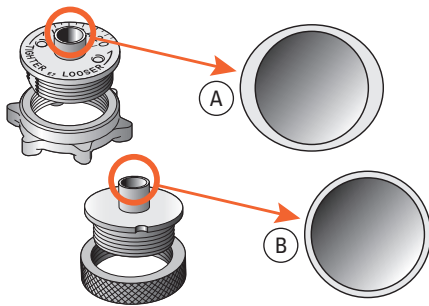

**5-1** The Leigh eBush barrel is elliptical **A**, unlike plain circular template guidebushes **B**. When rotated, the effective diameter of the barrel changes, allowing fit adjustments as small as .001" [0.025mm]. The e10 eBush is included with the R9PLUS.

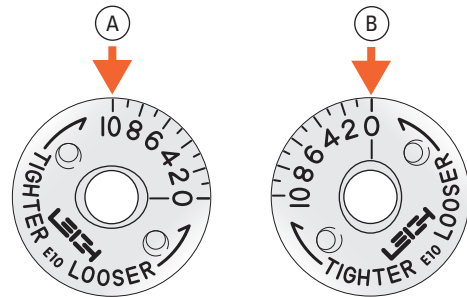

**5-2** With the eBush turned to "10" **A** in the base the active "diameter" is increased, allowing less side-to-side movement, resulting in smaller sockets and larger pins. Turning the eBush to "0" **B** allows more side-to-side router/bit movement and more wood removal, producing larger sockets and smaller pins, and thus a looser fit.

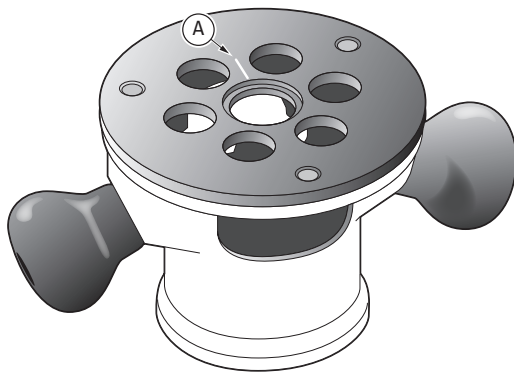

**5-3** Make a small scratch line or permanent ink mark on the router baseplate **A** or guidebush adaptor at the 12 o'clock position.

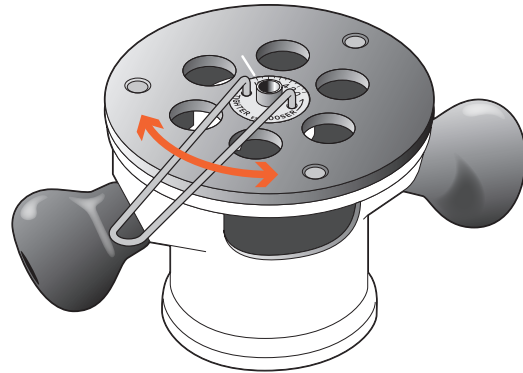

**5-4** All settings for the eBush will be aligned to the scratch or ink marks on the router. The eBush will always be set on index mark 5 as a starting point for dovetails and box joints.



**5-5** One division of the eBush changes the joint glue line by 0.002" [0.050mm]. A perfect fit will be established with one or two test cuts.

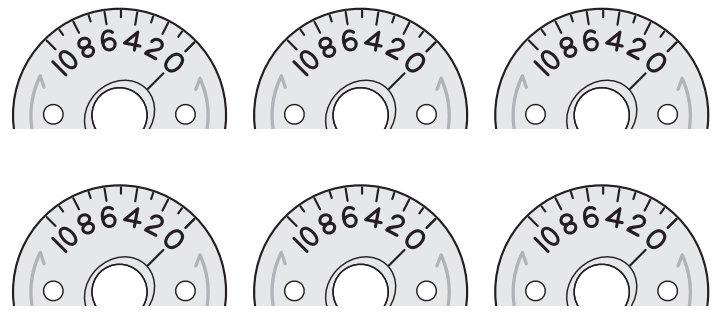

**5-6** Record the eBush setting here for a quick setup the next time you use this bit/guide bushing combination. ■

### eBushes and Adaptors

The Leigh eBush guide bushing fits directly to most popular router models such as Porter Cable, Black & Decker and Dewalt. Many other makes, e.g., Bosch, Fein, Festool, Milwaukee, etc. either offer or come complete with base adaptors that accept the eBush. In addition Leigh offers the nine adaptors below to allow the use of over one hundred other router models, new and old. For the complete list of routers, see the eBush Adaptor Selection chart on the next page.

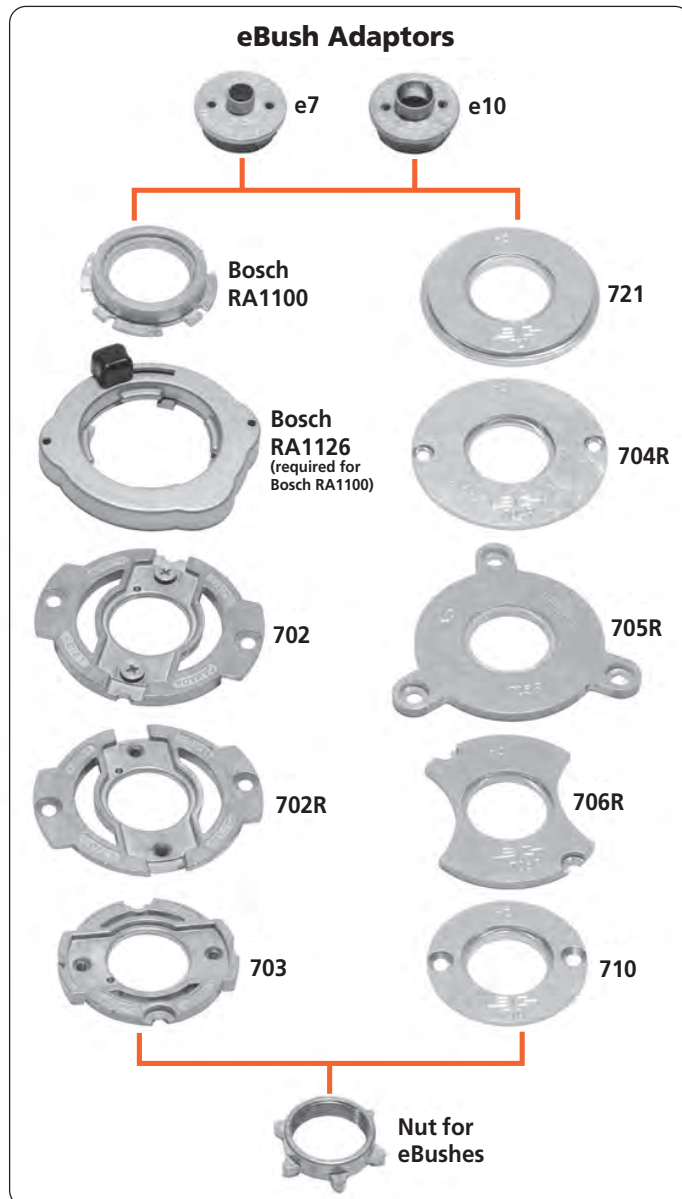

### eBush Mounting Variations

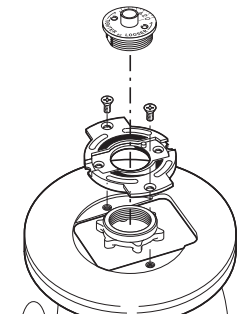

eBush with  
Adaptors 702 & 702R

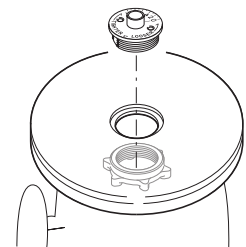

eBushes fit many  
routers directly

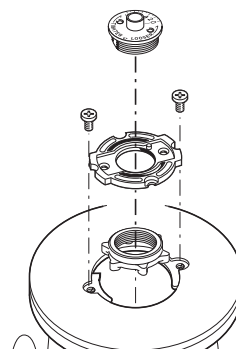

eBush with  
Adaptor 703

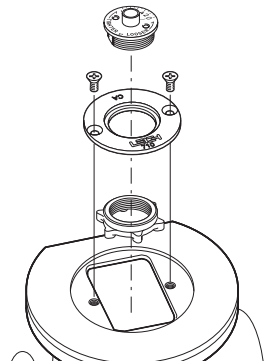

eBush with  
Adaptor 710

## eBush Adaptor Selection

In order to fit your Leigh eBush to your router, you may need an adaptor. Find out in the chart below.

See [www.leighjigs.com](http://www.leighjigs.com) for the complete list of routers.

### DIRECTIONS

- Locate name of router maker in Column 1.
- Locate router model in Column 2. If your router is not listed visit [leighjigs.com](http://leighjigs.com) for a complete, up-to-date list of routers.
- Locate adaptor required for your router in Column 3.
  - Order Leigh adaptors (part no's in red) in Column 3 from Leigh.
  - Order Bosch adaptors RA1100 and RA1126 in Column 3 from Leigh or your Bosch dealer.
  - Order all other adaptors in Column 3 from the router manufacturer's dealer.

■ MAFELL – Rework adaptor slightly.

### Router not listed?

If your router is not listed in this chart, you may be able to fit a “universal baseplate” to your router. Please contact Leigh for assistance.

### Adaptor Mounting Screws

Screws are included with router.

### Adaptors for Router Tables

Leigh guide bushings and eBushes are based on the industry standard 1-3/8" 2-piece design. Most router tables have adaptors that accept these standard guide bushings. If your router table does not have a suitable adaptor, please check with the router table manufacturer.

### Guide Bushings

All 8mm shank through dovetail bits listed in this chart work with either the e7 bushing (7/16" OD) supplied with your Leigh jig, or with any 7/16" OD guidebush. The optional Leigh e10 bushing or standard 5/8" OD guidebush is used with 1/2" shank bits. No other guidebush sizes can be used for through dovetails.

1 ROUTER MAKER	2 ROUTER MODEL	3 ROUTER ADAPTOR
BLACK & DECKER	All Professional, HD1250, RP400K,7614	Not Required
	6200	720673-00
	SR100, 7AEE, KW780 series, KW 800, KW850	710
BOSCH	1600, 90085, 90088, 90098, 90140, 90150, 90300, 90303, 90305, 91264	Aftermarket base plate required
	1601, 1602, 1603, 1604, 1606, B1350	RA1110
	North American ROUTERS PRODUCED AFTER mid-2010: 1613EVS, 1613AEVS, 1617, 1617EVS, 1618, 1618EVS, 1619EVS, MR23EVS, MRC23EVS, MRF23EVS, MRP23EVS	RA1126 quick change adaptor and RA1100 bushing adaptor required
	North American ROUTERS PRODUCED BEFORE mid-2010 and others available worldwide that include the RA1126 adaptor: 1613, 1613EVS, 1613AEVS, 1614, 1614EVS, 1617EVS, 1618EVS, 1619EVS, B1450, GOF900, GOF900CE, GOF900ACE, GOF1200, GOF1300CE, GOF1300ACE, GOF1600CE, GOF2000CE, GMF1400, GMF1600CE, POF800ACE, POF1100AE, POF1200AE, POF1400ACE	RA1100
	1611, 1611EVS, 1615, 1615EVS, B1550, GOF1600, GOF1700ACE	702
CMT	1E	702R
CRAFTSMAN (SEARS)	All non-plunge models	Aftermarket base plate required
	135275070 Plunge	See Skil 1823 or 1835
	Other plunge models	702
	MD11 Plunge & Fixed Base, MD9.5 Fixed Base	Not Required
DEWALT	DW610, DW616, DW618	Not Required
	DW613, DW615(UK)	710
	DW614, DW615, DW621, DW624, DW625, DW626	N. America Only, Supplied w/router
	DW621K & DW626 outside N. America	706R
	DW625 Type 1,2,3,5 outside N. America	702
	DW624 & DW625 Type 4 outside N.America, DW625EK	702R
		706R
ELU	OF15, OF15E, OF97, OF97E	710
	MOF68, MOF69, MOF96, MOF96E	702
	MOF131, MOF177 Type 1,2, & 3	702R
	MOF177 Type 4, MOF177EK	702R
	2720, 2721, 3328	Not Required
	3303, 3304	E09600 or 761 270-00
	3337, 3338, 3339	702
FEIN	RT1800	Supplied w/router
FESTOOL	OF1E, OF2E, OF650, OF900E, OF1000, OF1010E	704R
	OF2000, OF2000E	705R
	OF1400 and OF2200 North America Only	Supplied w/router
	OF1400 Outside North America	493566
	OF2200 Outside North America	494627 O-Ring may be required to keep bushing centered
FREUD	FT700(2), FT2000, FT2200, FT3000	721
HITACHI	TR8, TR12, FM8, M8, M12 Series	325211 OR 703
	M12VC, KM12SC, KM12VC	Not Required
	M12SA2, M12V2	325224
MAFELL	LO65E	702 ■
MAKITA	RP1801, RP2301, 3612C Europe Qk Fit Base	721
	3600, 3606, 3608, 3612, 3612B, 3612BR, 3612C N. America, 3620, 3621, RP900K	703
	3601B	321 493-1
	RP0910, RP1110C	706R
	RF1100, RF1101, RD1100, RD1101, RP1101	Not Required
MASTERCRAFT	Please contact Leigh for assistance	
METABO	OF1612, OFE1812 (for all others, please contact Leigh for assistance)	704R
MILWAUKEE	5615, 5616, 5619	49-54-1040
	5625	49-54-1026
	5670	Not Required
PERLES	OF808 Series, OFE6990	710
PORTER CABLE (ROCKWELL)	All	Not Required or Supplied w/router
RIDGID	R2930 (for all others, please contact Leigh for assistance)	704R
RYOBI	R30, R50, R150, R151, RE155, R500, R501, R502	703
	R600, R601, RE600, RE601	702
	R160, R161, R162, R163K, R165, R170, R175, RE175, R180, R180PL, R181, R185, ERT1150	706R
SKIL	1823 or 1835	91803
	SK1810, 1815, 1820, 1825	RAS140
	All others	Aftermarket base plate required
TREND	T3, T4, T5, T9, T10, T11 – UniBase required	710
TRITON	TRC001	TGA006 or 704R
	JOF001, MOF001, TRA001	Accessory Kit (includes adaptor) TGA001 or TGA150
WEGOMA	OF850 Series	710

