



## Router Joinery Jigs

### Leigh D1258 and D1258R User Guides

#### **\*\* Important Note\*\***

User Guides for the Leigh D1258 and D1258R are no longer in print. The User Guide for the D4 dovetail jig is directly applicable to the D1258 series jigs. Although some of the jig parts differ slightly in appearance, all procedures for Through, Half-blind, Sliding dovetails and more, remain the same.

The current D4R User Guide may be used, but the **D4** User Guide is more applicable and it can be viewed and downloaded free from this web site, and printed if desired. Hard copies are no longer available.

If you wish to purchase the D4R manual, you may order online at <http://www.leighjigs.com/manuals.php>, or on our toll free line – 1 800 663-8932. Please use part #25.

Jig upgrades are available to convert your older jig to D4 Specifications. Upgrade kits may be seen at the following link; <http://www.leighjigs.com/upgrades.php>.

All technical bulletins for 24" D Series jigs may be used with the D1258 and you may access these at the following link; <http://www.leighjigs.com/support.php#r12>.

Thank you.

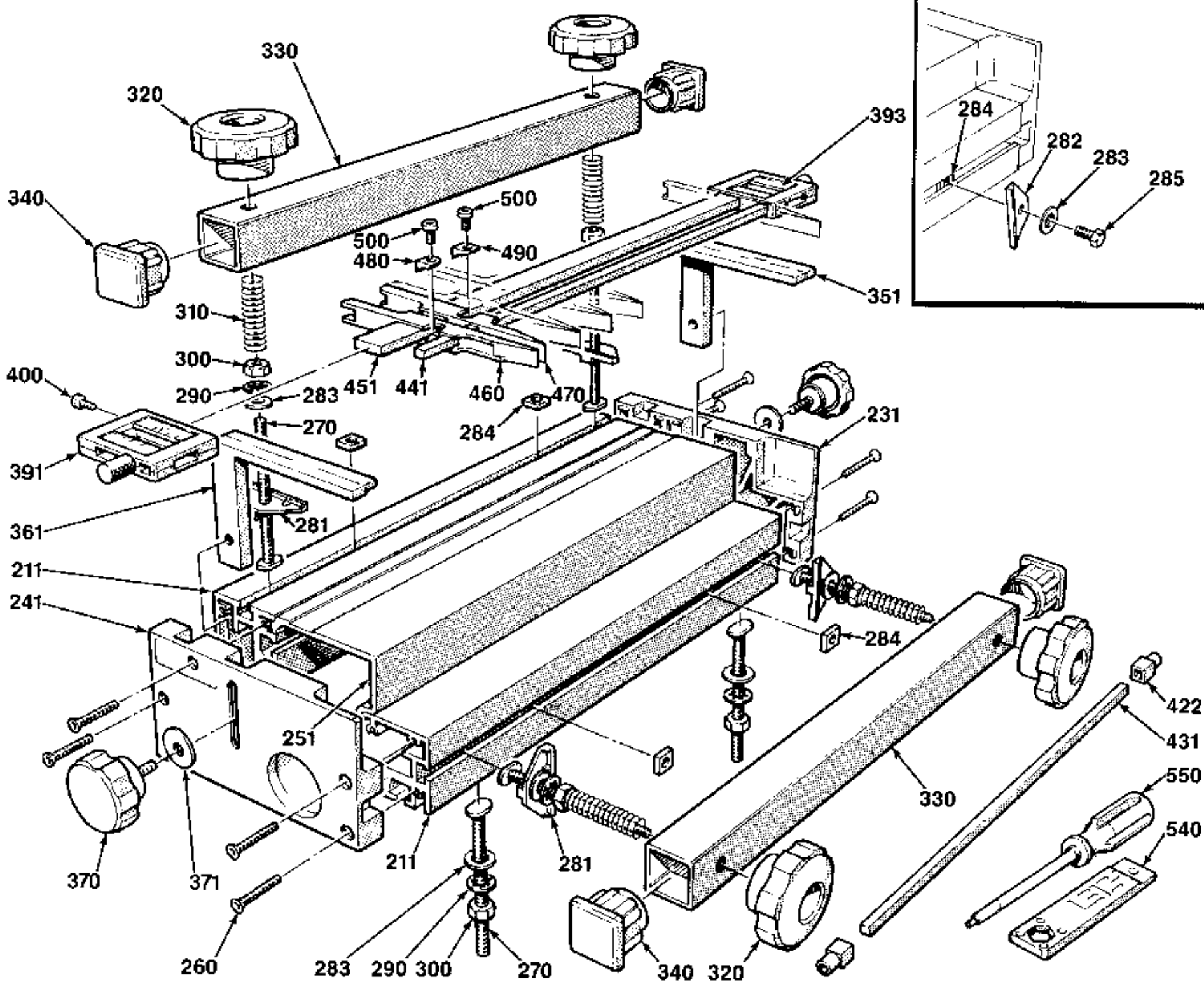

## PART NO.

## QUANTITY

## DESCRIPTION

D1258R-12 D1258R-24

PART NO.	QUANTITY	QUANTITY	DESCRIPTION
	D1258R-12	D1258R-24	
211	2	2	Front Body Extrusion/Rear Body Extrusion
231	1	1	R.H. End Housing
241	1	1	L.H. End Housing
251	1	1	Body Cover
260	8	8	End Housing Screws
270	6	6	Clamp Bar T Bolts/Jig Hold Down T Bolts
281	4	4	Fixed Side Stops
282	4	4	Angle Side Stops
283	10	10	Side Stop, Angle Side Stop and Jig Hold Down Flat Washers
284	4	4	Angle Side Stop Square Nuts (1/4 x 20)
285	4	4	Angle Side Stop Bolts (1/4 x 20)
290	6	6	Clamp Bar Bolt Loc Washers
300	6	6	Clamp Bar Bolt Nuts/Hold Down Bolt Nuts (5/16 x 18)
310	4	4	Clamp Bar Springs
320	4	4	Clamp Bar Knobs
330	2	2	Clamp Bars (c/w End Plugs)

**PART NO.****QUANTITY****DESCRIPTION**

D1258R-12 D1258R-24

---

	D1258R-12	D1258R-24	
340	4	4	Clamp Bar End Plugs
351	1	1	R.H. Support Bracket
361	1	1	L.H. Support Bracket
370	2	2	Support Bracket Knobs
371	2	2	Support Bracket Knob Washers, Nylon
391	1	1	R.H. Scale Assembly, Complete (R.H. in "HB" Tail Mode)
393	1	1	L.H. Scale Assembly, Complete (L.H. in "HB" Tail Mode)
400	2	2	Scale Screws (8-32)
422	2	2	Cross Cut Bar Cap
431	1	1	Cross Cut Bar (1/4 x 1/4 CRS)
441	1	1	HB Pin Guide Rail (1/4 x 1/4 CRS)
451	1	1	Finger Guide Rail (1/4 x 3/4 CRS)
460	10	13	R.H. Finger c/w Bevel Nut and Screw
470	10	13	L.H. Finger c/w Bevel Nut and Screw
480	10	13	R.H. Finger Bevel Nut
490	10	13	L.H. Finger Bevel Nut

---

**PART NO.****QUANTITY****DESCRIPTION**

D1258R-12 D1258R-24

---

500	20	26	Finger Lock Screws (8-32 x 310" P.H.)
540	1	1	Leigh Assembly Wrench/Gauge
550	1	1	Finger Adjusting Screwdriver (#2 Robertson)
#80	1	1	1/2" x 8° x 13/16 Deep Dovetail Cutter (Not Illus.)
#140	1	1	5/16" Straight Cutter (Not Illus.)
Note			Cutters Often Shipped Separately by Supplier.
	1	1	Instruction Manual
	1	1	Assembly Instructions

---