

September 2004  
UPDATE

# How To Rout Wide Double Joints On Your Leigh *FMT* Jig

(Up to 8-3/4" and even 10-1/2" boards)

 These instructions are based on the assumption that you are fully conversant with the Mortise & Tenon instructions in the Leigh FMT Jig User Guide. Do not attempt the following procedures until you are.

## W I D E   D O U B L E   J O I N T S

Make sure all the tenon workpieces are exactly the same width. When marking out the tenons, ensure that they are equidistant from the rail centreline. This eliminates any potential asymmetry problem when making all the mortises from a common stop position.

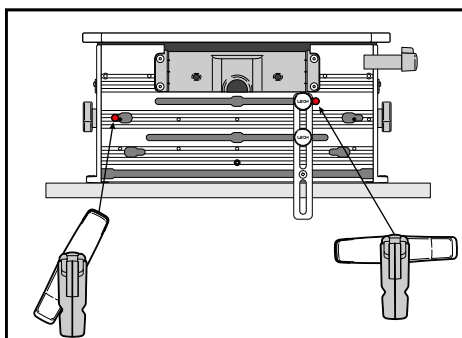

- 1** Before starting this procedure establish the correct guide pin position for good joint fit. Position the side stop fence and clamps as shown and approximately centre the table.

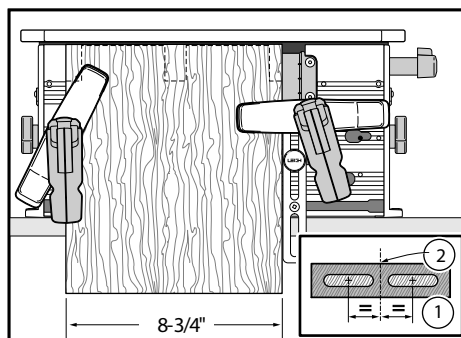

- 2** Mark one pair of tenon centres only, equidistant from the rail center (1). Allow sufficient spacing for the cutter to pass between the tenons (2).  
e.g. 3-1/2" tenons on 8-3/4" board at 4-1/4" centres using 1/2 x 2-1/2" guide and 1/2" cutter.

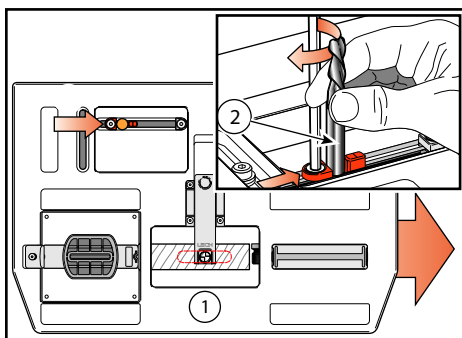

- 3** Sight over the right hand tenon (1). Use a 1/2" drill bit to position the left limit stop (2).

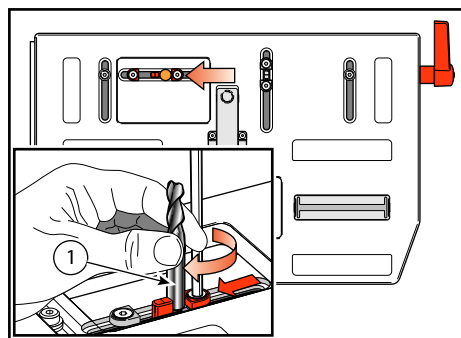

- 4** Use same 1/2" bit to position RH limit stop. The table can now be moved 1" left and right.

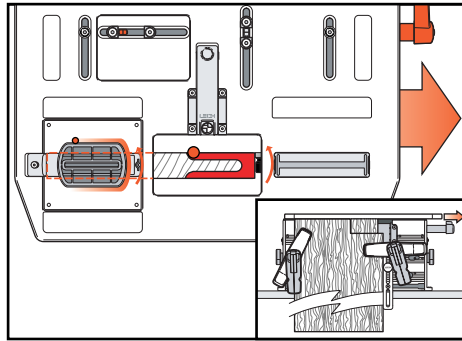

**5** Move the table to the right and rout around with the guide pin running around the right end of the guide.

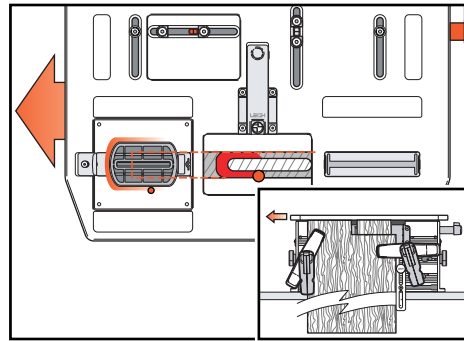

**6** Move the table to the left and run the guide pin around the left end of the guide. Take care not to rout too far left (into the left hand tenon) or use a guard in the guide recess.

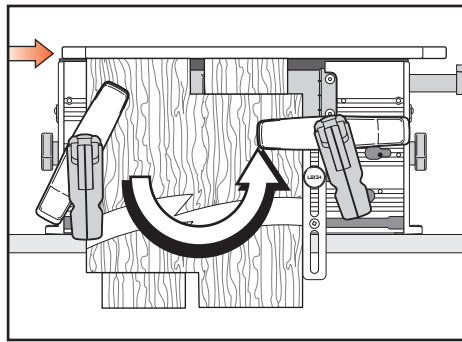

**7** Turn the first board around in the jig (same side face inwards) and repeat steps 5 thru 6 on this board and all rail ends.

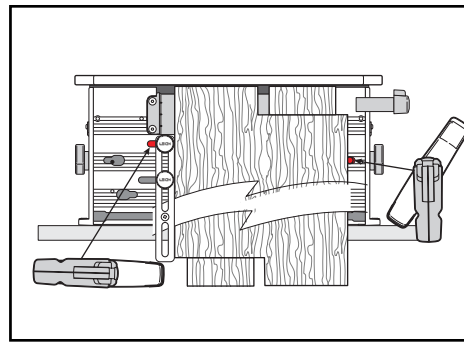

**8** Reverse the position of the side stop and clamps and position the original end of board one and clamp. Sight on the centre of the left tenon and reposition the limit stops using the 1/2" drill.

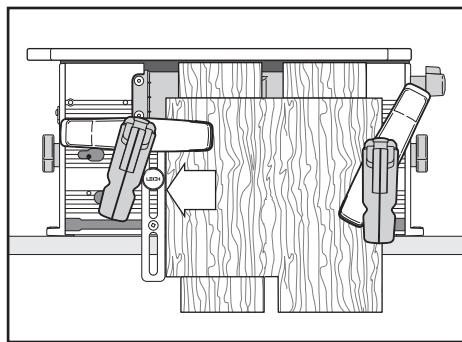

**9** Repeat steps 5 and 6 on this end

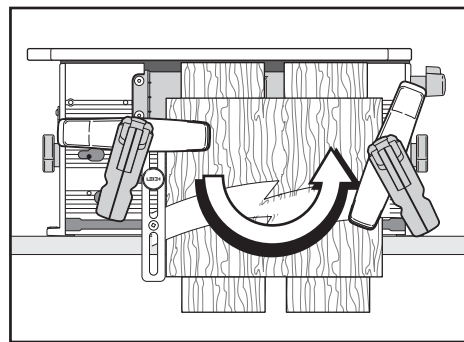

**10** And again on the other end. Repeat on all rail ends.

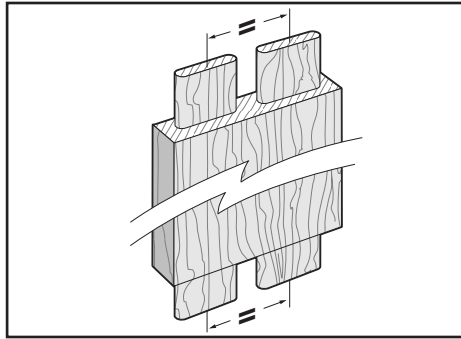

**11** Now all rail ends of the bed rail have tenons exactly the same distance apart on centres.

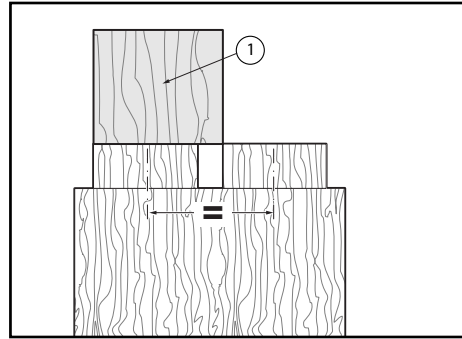

**12** **Mortises**  
Make a "centre distance" block exactly this length ①. i.e. Tenon width plus gap width equals tenon centre distance.

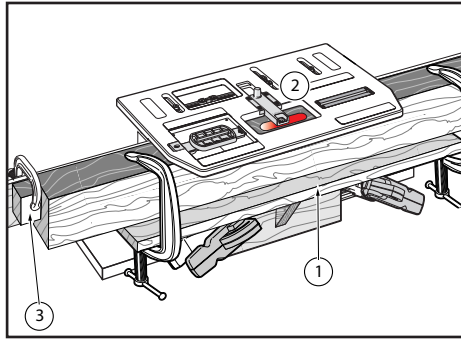

**13** Set up the left hand outrigger and auxiliary post-mounting bracket ①. Mark a test sample post and sight the right mortise ②. Attach a stop block to the outrigger ③. Rout the right hand mortise.

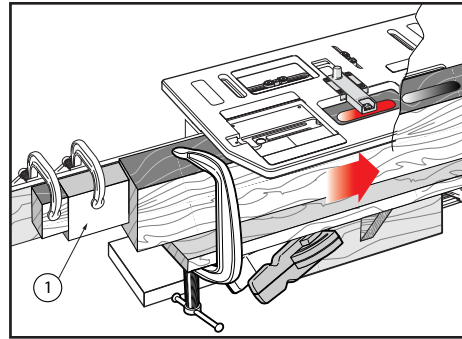

**14** Unclamp and move the test post. Clamp the "centreline distance" block against the first stop block. Re-clamp the test post and rout the left mortise.

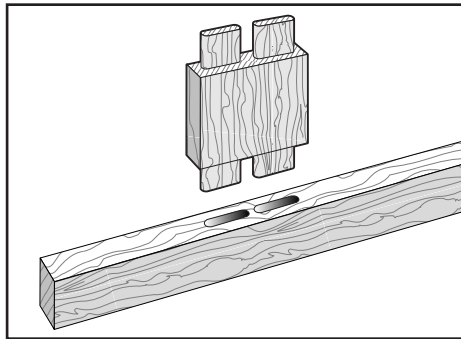

**15** Test the joint for alignment and if necessary, adjust the "centreline distance block" to suit.

## EXTRA WIDE DOUBLE JOINTS

### Up to 10-1/2" Boards

This procedure is similar to "wide double joints" except for the positioning of the clamps

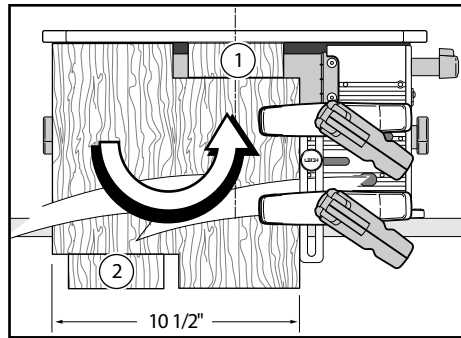

**16** Rout RH tenon ①, then rotate to rout the bottom tenon ②.

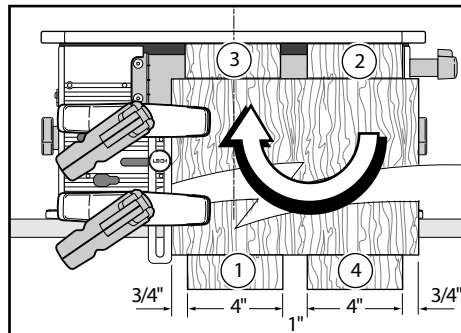

**17** Reverse the position of the side stop and clamps and rout tenon ③. Rotate and rout tenon ④.

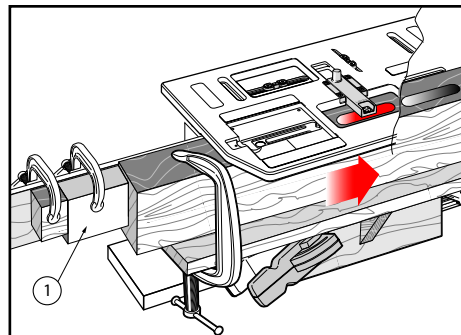

**18** Make up and use a centreline distance" block to rout the mortises (see instructions 12,13 and 14)