

F2, F1600 User Guide update November 2006

These illustrations and instructions replace their corresponding numbers in the printed User Guide that you received with your Leigh jig. You may wish to paste these over the illustrations in the User Guide. Because of recent design changes, leaving the Fence assembly on the Template interferes with the initial jig setup and centring procedure. These updated design changes, leaving the Fence assembly on the Template interferes with the initial jig setup and centring procedure. The Fence is used only for rounded finger joints, therefore it may be left off the jig until needed.

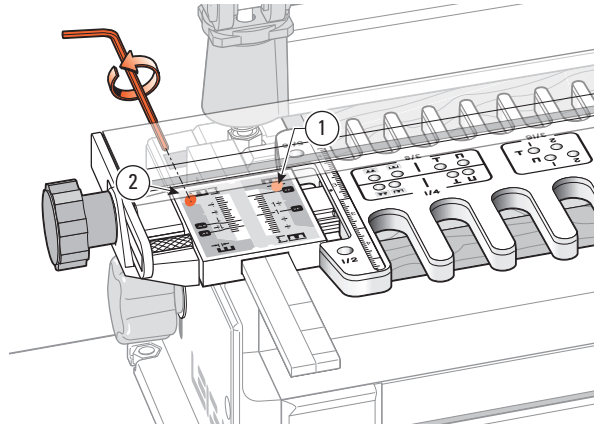

1-7

Tighten the scale bracket screws ②, at both ends of the template but **do not tighten the scale bar ① screws yet.**

Remove the fence for the remaining assembly steps.

Loosen and remove the fence knobs, spring washers, bolts and fence, then re-assemble the pieces off of the template and store in a safe place. The fence is shown throughout the manual, however it is only used for rounded finger joints, so you may wish to leave it off the template.

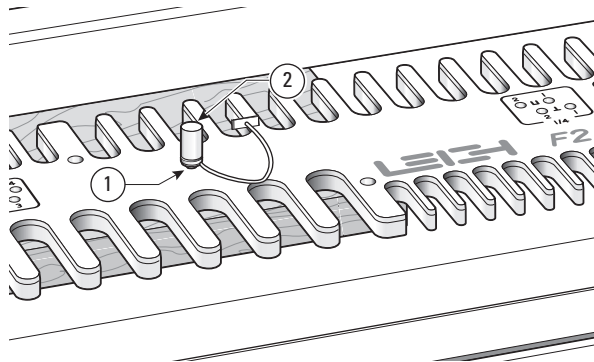

1-8 Centring the F2

For F1600 centring, see 1-11

Align the template so that the template's centre hole ① lines up with the hole in the bar and insert the template pin ②. *Discard the shipping plug from the hole.* Gently twist and push the tapered pin into the hole until it is fully seated. The template is now perfectly centred on its bar, but now we must centre the bar in the scales.

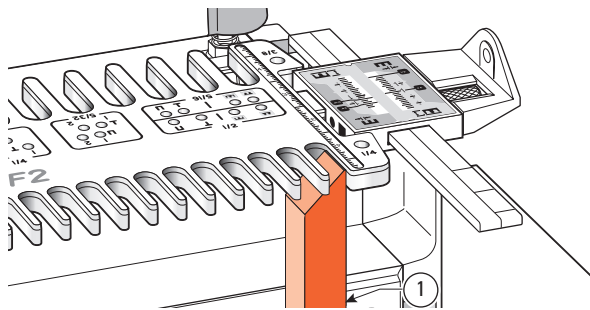

1-9

Angle trim the end of a perfectly straight block. Slide the combined bar/template to allow the block to protrude into the last socket of the ¼" [12mm] comb. Clamp with its vertical edge tight against the right hand side stop ①.

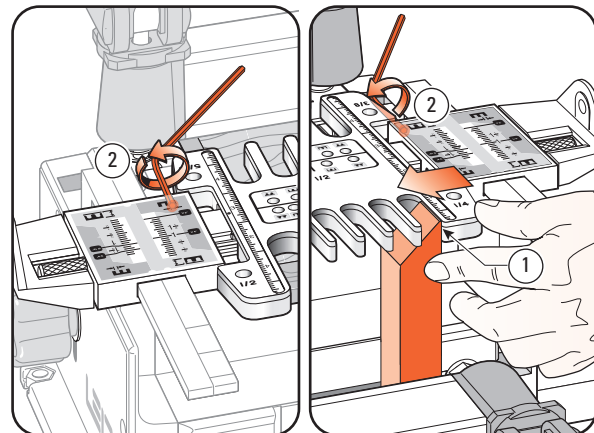

1-10

Move the combined template and bar to the left until the right side of the outer ¼" [12mm] opening touches the block ①. Taking care to not move the template assembly, tighten the scale screw on the left hand scale ②, then remove the pin and slide the template to the left. Now tighten the scale screw on the right hand scale ②. Remove the wood block and your Leigh F2 assembly is complete, ready for use.

Attach the fence if you are routing rounded finger joints.