

February 2004
 UPDATE

How To Mount Shaped Mortise Pieces On Your Leigh *FMT* Jig

 These instructions are based on the assumption that you are fully conversant with the Mortise & Tenon instructions in the Leigh FMT Jig User Guide. Do not attempt the following procedures until you are.

MOUNTING SHAPED MORTISE PIECES

A. Curved Shape

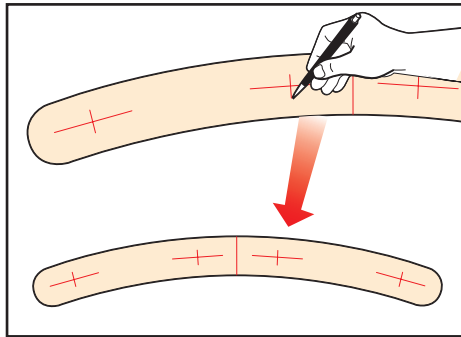
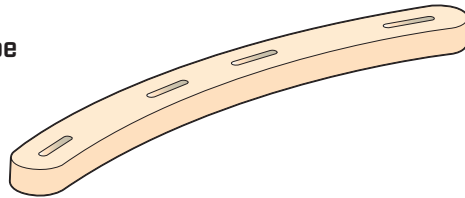

1 On flat curved surfaces such as this where the mortise is not automatically parallel to the clamp plate, make sure you extend the long axis mortise centreline mark to extend well beyond the mortise area.

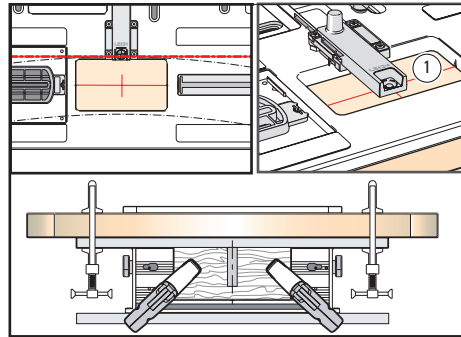

2 Mount your shop made auxiliary bracket to the FMT and "sandwich" the mortise board under the table. Adjust the workpiece so that the long joint axis line is parallel to the jig; either by measurement or by aligning with the two centreline marks in the table opening ① (later model FMTs)

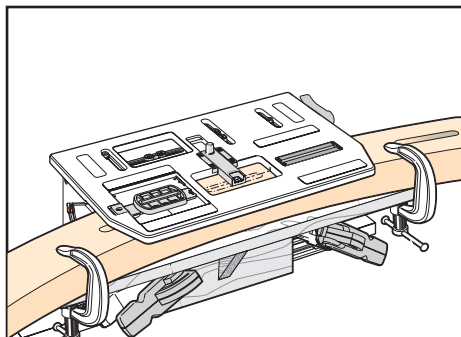

3 Unlock the table, sight the mortise and lock the table.

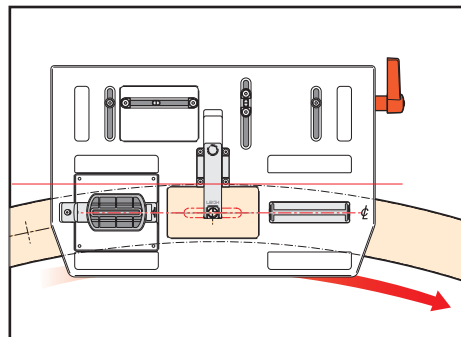

4 Rout mortise, release clamps and move workpiece to sight the next mortise axis guide lines. Adjust the table as necessary for each mortise.

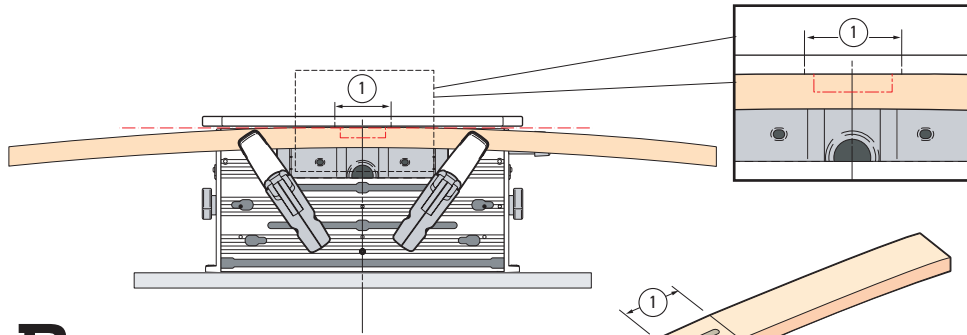

B. Convex Shape

To match the shoulder of the tenons make sure the workpiece has a straight flat area ①

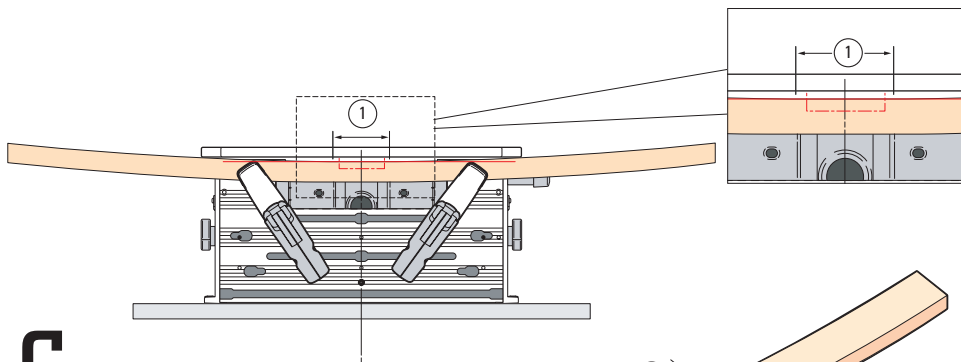

C. Concave Shape

The FMT effectiveness will depend entirely on how close the active joint area can be to the table. The Tenon shoulder area must again be straight and flat ① to accept the tenon shoulder.

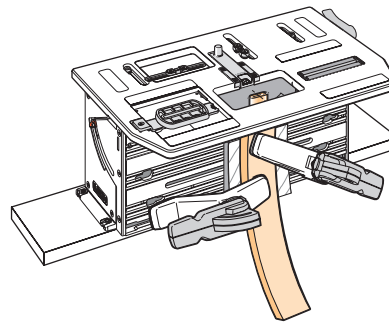
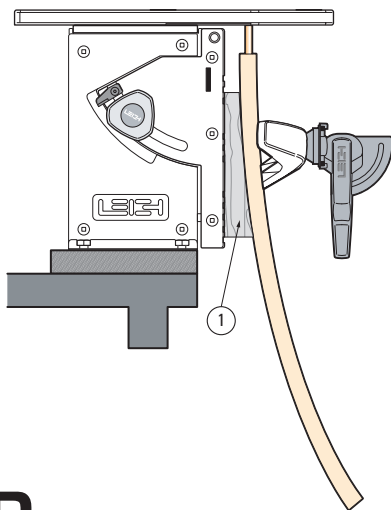

D. Routing Tenons on Shaped Pieces

To hold curved pieces for routing tenons, we recommend using the clamp plate through holes to attach a shop made shaped clamping block ①.

© Leigh Industries Ltd. All rights reserved.

The purpose of this publication is to assist in the use of products produced by Leigh Industries Ltd. The procedures described in this publication are suggestions only. The user shall determine risk and assume responsibility for personal safety practises, and is solely responsible for any consequences of following these guidelines.

This pdf version of this publication is intended for personal, non-commercial use only and may be downloaded and stored on a personal computer and printed, viewed, and freely distributed for operational guidance and evaluation purposes. Any such downloading, storage, printing, viewing or distribution must maintain the entire pdf version of the User Guide intact in its entirety and in its original form. Except as provided herein, no part of this document may be reproduced, sold, published, distributed, modified, displayed, reposted or otherwise used without the prior written permission of Leigh Industries Ltd. [revision date]