

Router Preparation

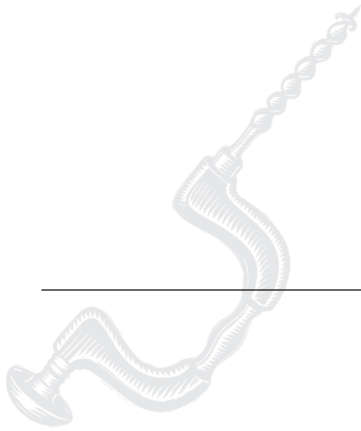
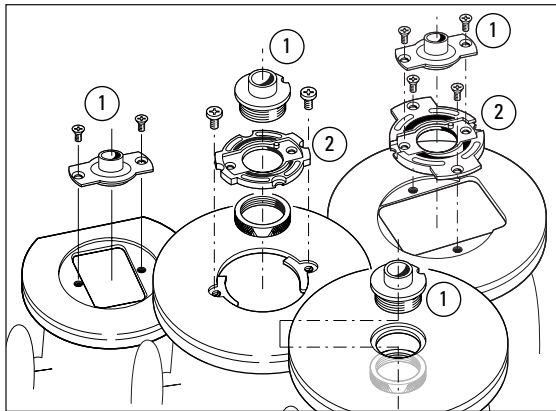
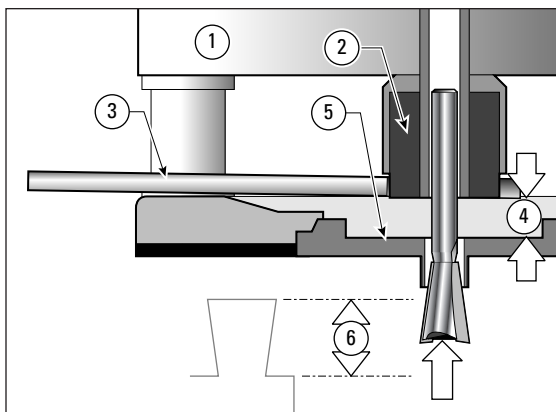

**7-1**

The router of course, must always have the correct size of Guidebush fitted ①. Only two sizes are used for dovetailing, $\frac{7}{16}$ " [11,1mm] O.D. for all halfblind and smaller through dovetails, and $\frac{5}{8}$ " [15,9mm] O.D. for the largest through dovetail joints. Your router base may also require a guidebush adapter ②. Please see Appendix I, page 149 "Guidebush Selection".

**7-2**

When fitting a cutter to the router ①, **always fit the cutter shank as deeply into the collet ② as possible.** Always rout with the collet as close to the cutter head as possible. Usually you will not be able to get the collet wrench ③ securely on the collet nut with the collet at its optimum low position, so fit the cutter into the collet so that the remaining travel ④ between the collet and the guidebush ⑤ will let the cutter reach the required depth of cut ⑥.

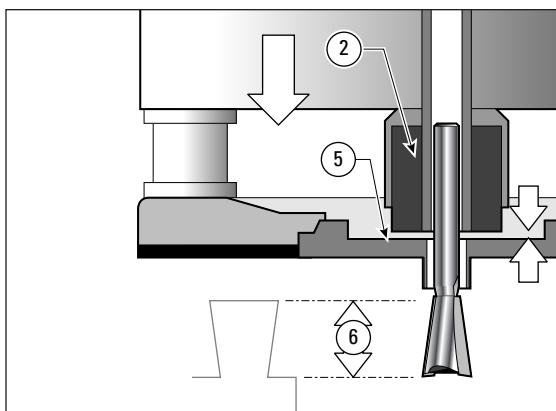
**7-3**

Tighten the collet ② securely and lower the collet to adjust the depth of cut ⑥, but make sure the collet does not contact the guidebush ⑤.

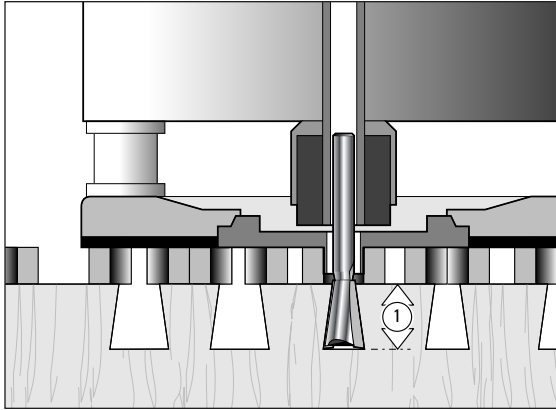
**7-4 Depth of Cut:**

The depth of cut always refers to the actual depth ① of the cut into the wood beneath the guidefingers.

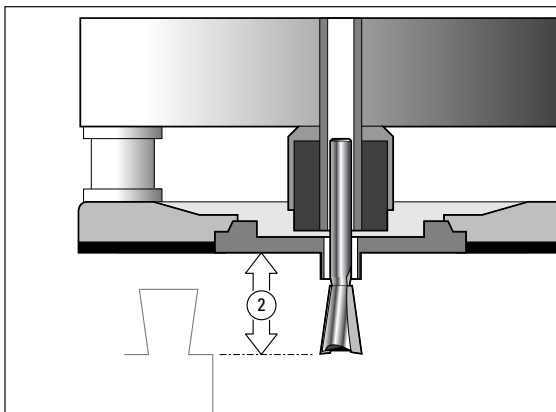
**7-5**

Depth of cut is not the distance the cutter projects from the router base. This is cutter projection ②. This manual will always refer to depth of cut. (Cutter projection ② is always .450" [11.5mm] more than depth of cut).